



6212-RS1 Deep groove ball bearings

- SKF Explorer

Deep groove ball bearings

Bearing data

[Tolerances](#),

Normal (metric), P6, P5, Normal (inch),

[Radial internal clearance](#),

Matched bearing pairs, Stainless steel
 $d < 10$ mm, Other bearings

Bearing interfaces

[Seat tolerances for standard conditions](#),

[Tolerances and resultant fits](#)

Technical specification

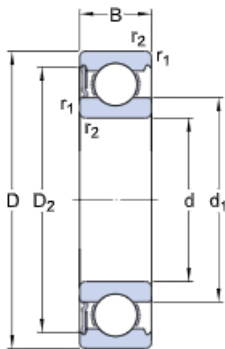

DIMENSIONS

d	60 mm	Bore diameter
D	110 mm	Outside diameter
B	22 mm	Width
d_1	≈ 75.5 mm	Shoulder diameter
D_2	≈ 98 mm	Recess diameter
$r_{1,2}$	min. 1.5 mm	Chamfer dimension

ABUTMENT DIMENSIONS

d_c min.	69 mm	Diameter of shaft abutment
d_c max.	75.4 mm	Diameter of shaft abutment
D_i max.	101 mm	Diameter of housing abutment
r_a max.	1.5 mm	Radius of shaft or housing fillet

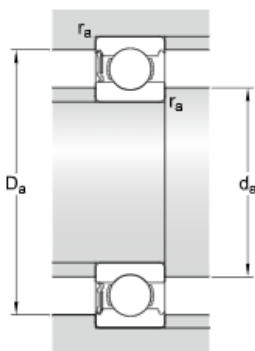

CALCULATION DATA

C	55.3 kN	Basic dynamic load rating
C ₀	36 kN	Basic static load rating
P _u	1.53 kN	Fatigue load limit
	4 000 r/min	Limiting speed
k _r	0.025	Minimum load factor
f ₀	14.3	Calculation factor

MASS

	0.79 kg	Mass bearing
--	---------	--------------

TOLERANCE CLASS

P6	Dimensional tolerances
P6	Radial run-out